

Product Data Sheet	G12MF, MM, FM Type 2 Valve Manifold
---------------------------	--

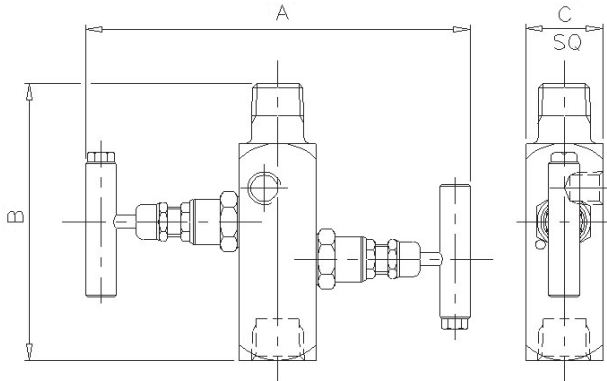

The 'G12' Type 2 valve manifold is designed for remote mounting to static pressure transmitters. The separate vent valve gives full control of venting of the instrument, plus the ability to calibrate in-situ. Each needle valve head is designed for safe and reliable isolation, giving bubble tight shut off, with non-rotating & anti-galling tip and dynamic self-adjusting spindle seal to give long service life in a variety of service conditions.

Part No.	Connections Size	A	B	C	Weight (Kgs)
G12MF	1/2" M x F	6.3	4.7	1.3	0.9
G12MM	1/2" M x M	6.3	5.4	1.3	0.9
G12FM	1/2" F x M	6.3	4.7	1.3	0.9

Key Features of the Oliver Needle Valve range

- Non rotating tip - self centering & anti-galling
- Piston ring - gives dynamic adjustment of gland seal in response to pressure change
- Anti-blow out spindle - a major safety feature
- Secure seal - precision machined to give leak free operation for the life of the valve. Available in either PTFE or Grafoil

Standard Specification

Pressure: 6000psi	Packing: PTFE	Handle: T-Bar	Bore: 0.21" (5.4mm)
Temp: 240 deg C	Thread form: NPT	Seat: Metal to metal	CV: 0.46
1/2" Inlet / Outlet Connections		1/4" NPT Vent Connection	

Ordering Code

	(Typical example) →	G12MF	S	/	BT	/	AT
Type							
G12MF - Male x Female G12MM - Male x Male G12FM - Female x Male							
Material							
S - 316S31 Stainless Steel M - Monel (400)			HC - Hastalloy (C276) (Others available)				
Optional Connections (NPT Standard)							
BT - BSP Taper BP - BSP Parallel (top sealing) BTV - BSP Taper Vent BPV - BSP Parallel Vent			BW-SCH*** - Butt weld (Schedule ***) FSW - Female Socket Weld MSW - Male Socket Weld				
Options							
AG - Grafoil AT - Anti-Tamper BKTC - Carbon steel mounting bracket BKTS - Stainless steel mounting bracket HL - Handle Locking HL-PI - Handle Locking + Position Indicator HP - 10000 psi HW - Hand Wheel LT100 - Cryogenic Head Unit (-100°C)			LT200 - Cryogenic Head Unit (-200°C) MT - Metering Tip MTG - Tapped Mounting Holes x 2 NA - NACE MR-01-75 (latest revision) OXY - Oxygen Cleaned PK - PEEK Soft Tip PP - Blank Plug In Vent Connection 2H - Straight through mounting holes x 2				