

Product Data Sheet	Y54 Type 5 Valve Manifold
---------------------------	----------------------------------

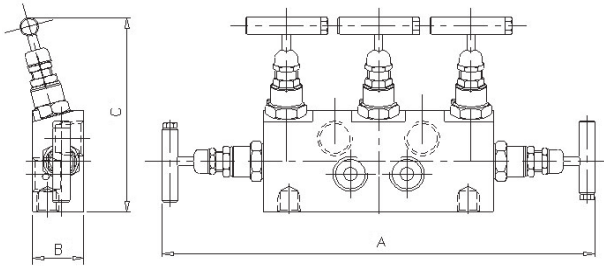

The 'Y54' Type 5 valve manifolds are designed for remote mounting to differential pressure transmitters, with separate isolation and vent for LP and HP inlets plus equalising valve for simple calibration. Each needle valve head is designed for safe and reliable isolation, giving bubble tight shut off, with non-rotating & anti-galling tip and dynamic self-adjusting spindle seal to give long service life in a variety of service conditions.

Part No.	Connections Size	A	B	C	Weight (Kgs)
Y54	1/2" F x F	10.6	1.3	4.8	2.3

Key Features of the Oliver Needle Valve range

- Non rotating tip - self centering & anti-galling
- Piston ring - gives dynamic adjustment of gland seal in response to pressure change
- Anti-blow out spindle - a major safety feature
- Secure seal - precision machined to give leak free operation for the life of the valve. Available in either PTFE or Grafoil

Standard Specification

Pressure: 6000psi	Packing: PTFE	Handle: T-Bar	Bore: 0.21" (5.4mm)
Temp: 240 deg C	Thread form: NPT	Seat: Metal to metal	CV: 0.46
1/2" Inlet and Outlet Connections		1/4" NPT Vent Connections	

Ordering Code

	(Typical example) →	Y54		S	/	BT	/	AT
Type								
Y54 - Female x Female								
Material								
S - 316S31 Stainless Steel M - Monel (400) HC - Hastalloy (C276) (Others available)								
Optional Connections (NPT Standard)								
BT - BSP Taper BP - BSP Parallel (top sealing) BTV - BSP Taper Vent BPV - BSP Parallel Vent FSW - Female Socket Weld								
Options								
AG - Grafoil AT - Anti-Tamper BKTC - Carbon steel mounting bracket BKTS - Stainless steel mounting bracket HL - Handle Locking HL-PI - Handle Locking + Position Indicator HW - Hand Wheel								
LT100 - Cryogenic Head Unit (-100°C) MT - Metering Tip MTG - Tapped Mounting Holes x 2 NA - NACE MR-01-75 (latest revision) OXY - Oxygen Cleaned PK - PEEK Soft Tip PP - Blank Plug Fitted In Vent Connection								